

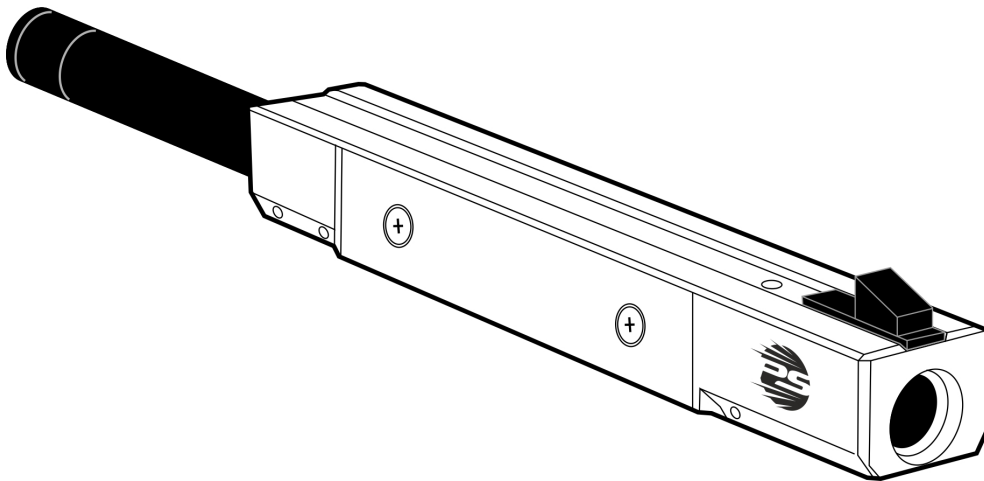

www.pentashot.eu

LB16 Laser Barrel

OPERATING INSTRUCTIONS



PREFACE

Before using the laser barrel, study the manual carefully. The manual must be considered an inseparable part of the product. For this reason, store it for future use.



The illustrations used in this manual may not correspond to the actual product. They are used solely to describe the main principles of the equipment and its settings. The texts, drawings, photographs and other elements are protected by copyright. Abusing them or copying them without authorization is subject to prosecution.

CONTENT OF SUPPLY AND UNPACKING

The laser barrel and its parts are supplied in an original case, containing the following:

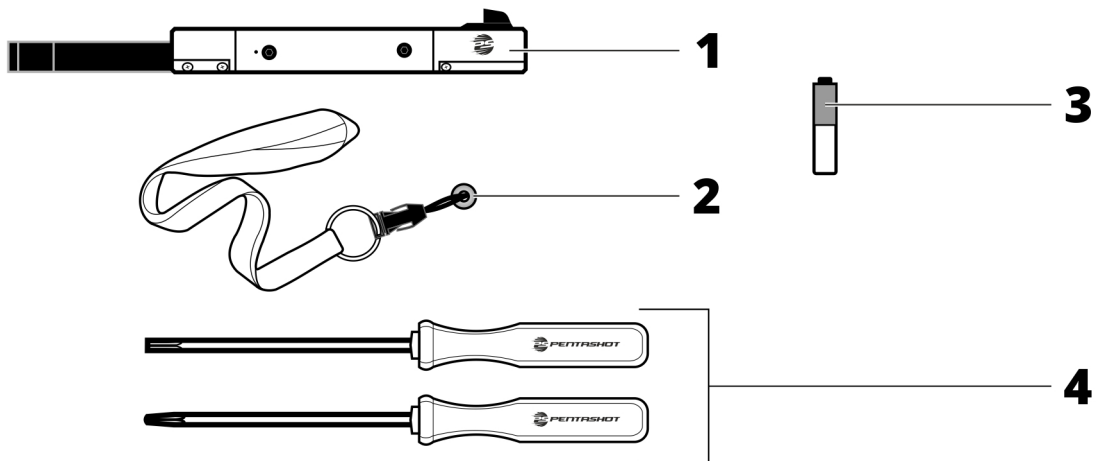

- | | |
|---|-----------------------------------|
| 1 | Laser barrel |
| 2 | Starting magnet |
| 3 | Battery AAA 1,5V Alcaline ((1pc) |
| 4 | Hexagonal screwdrivers |



Upon delivery or purchase, immediately check whether the product is damaged and whether it is the type you ordered. If it is the wrong product or is damaged, contact your seller immediately. If the claim isn't filed on time, it cannot be honoured.

If the case has been packed, ensure proper disposal and recycling. Dispose of it according to the waste legislation applicable in the product user's country.

INTRODUCTION

The LB16 laser barrel is designed for use at instructional courses, trainings or modern pentathlon competitions. It is intended for laser beam shooting initiated by a trigger.

The LB16 laser barrel employs the FLP20 laser module with a 15.6 ms code as an emitter. The code is fully compatible with the International Modern Pentathlon Union (UIPM) standards.

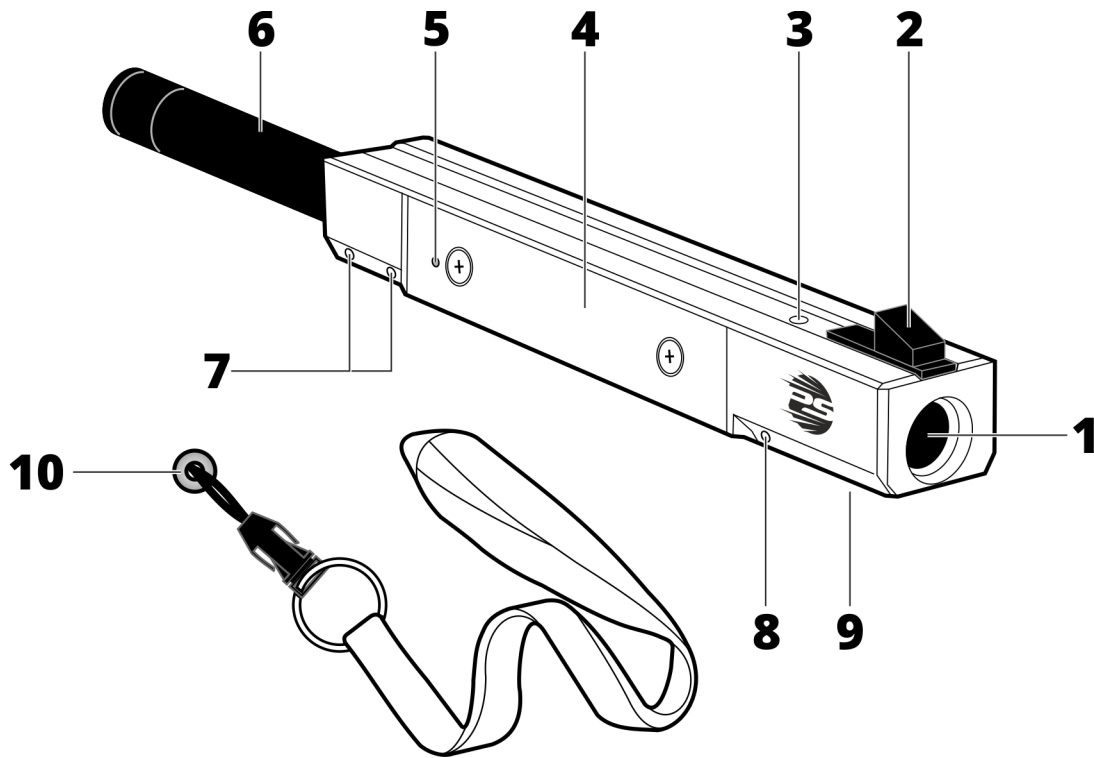

- | | |
|----|---|
| 1 | Side with emitter optics (lense) |
| 2 | Front sights (not included in delivery) |
| 3 | Laser dot alignment screw |
| 4 | Battery cover |
| 5 | Battery status LED indicator |
| 6 | Side for connection to gun/frame |
| 7 | Mounting screws |
| 8 | Laser dot alignment screw (right) |
| 9 | Laser dot alignment screw (left) |
| 10 | Starting magnet |

TECHNICAL DATA

BASIC DATA

Emitter type	Laser barrel
Overall dimensions	20 mm x 23 mm x 289 mm
Weight	170 gr (with aluminium adapter) 220 gr (with steel adapter)
Recommended shooting distance	up to 10 m

LASER

Laser module type	PENTASHOT FLP20
Laser class	I. (in accordance with EN 60825 - 1:2014 standard)
Wavelength	650 nm \pm 5 %
Laser beam diameter	4 mm \pm 5% / 10 m
Laser coding	15,6 ms UIPM laser signal
Laser class certificate	No.: 1140735 (ELECTROTECHNICAL TESTING INSTITUTE, Prague, CZECH REPUBLIC)
Minimum laser peak value (empty battery)	2,5 mW
Maximum laser peak value (full battery)	3,2 mW

OPERATION

Operating conditions	+10° C to +50° C; IP 52
Emitter power supply	1,5V AAA Alkaline battery
Number of shots made with 1 pc AAA type battery	min. 40 000 / at 20° C

CONNECTING TO A PISTOL FRAME

Connect the laser barrel to a laser gun frame, e.g. the PENTASHOT FLP12 frame, and fasten it using the two mounting screws (7). The front sights (2) must point upwards.

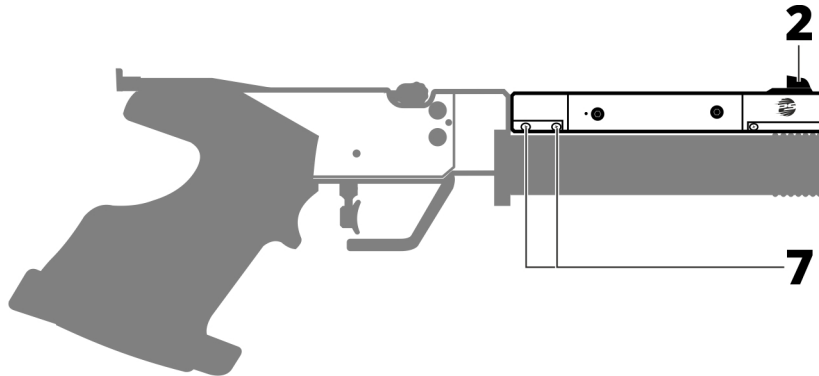

SWITCHING ON/OFF

SWITCHING ON

Attach the chip (10) to the laser barrel body and move it **from right to left**. This will switch laser barrel ON and the LED (5) will flash. The number of flashes indicates the battery status:

- 5 flashes – the battery is 100% full
- 4 flashes – the battery is at 75% charge level
- 3 flashes – the battery is at 50% charge level
- 2 flashes – the battery is at 25% charge level
- 1 flash – the battery is discharged, replace it.

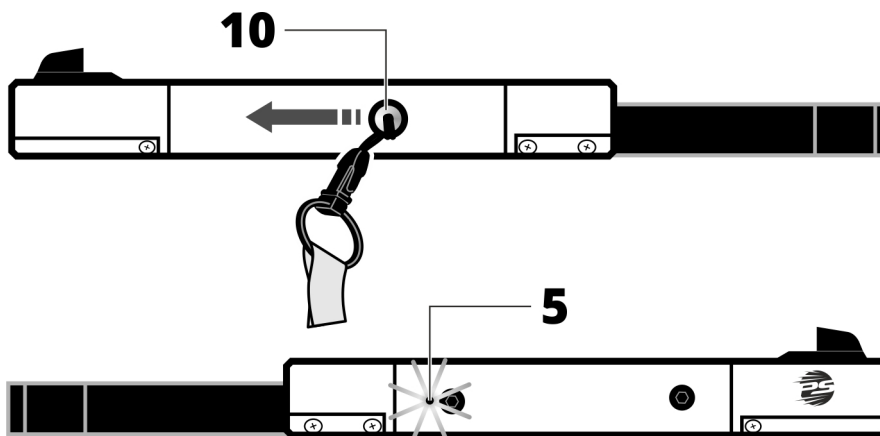

After the battery test, the LED light remains constantly blue to indicate the laser is on and ready for use.



The LED flashing continuously blue means the battery is discharged and it should be immediately replaced.

SWITCHING OFF

The laser barrel will switch off approximately 20 minutes after the last shot. In case you need to switch it off immediately, remove the battery from the laser barrel body.

SETTINGS

The user can only set or maintain the following:

- set the laser barrel sights (the laser dot position)
- set the trigger position, weight and travel
- change the battery



It is forbidden to open or modify the laser barrel, with the exception of changing the battery. The Laser beam parameters can only be changed by the manufacturer or an authorized person. The laser barrel owner must confirm his consent to the change in writing. The manufacturer does not assume responsibility for any damage that would arise from the change.

SETTING THE SIGHTS (ALIGNING THE LASER DOT)

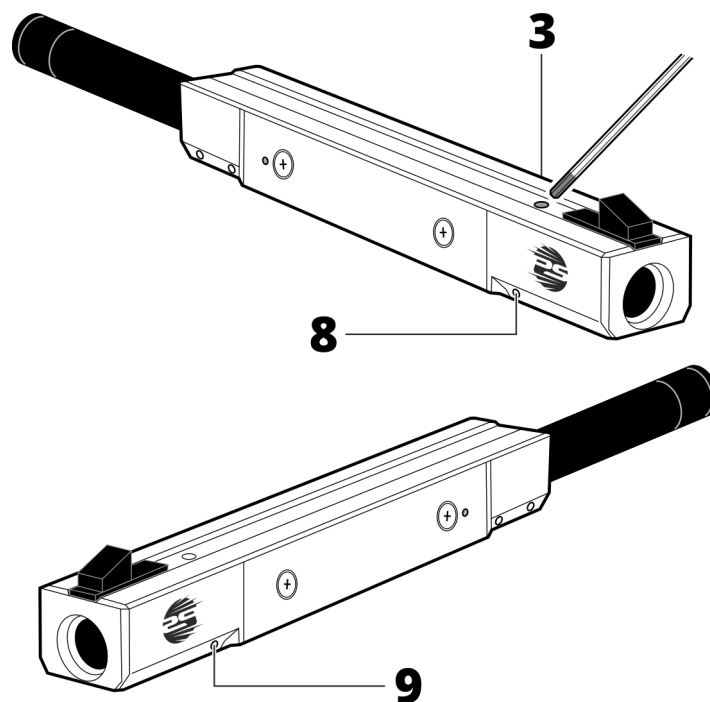

To adjust the position of the laser dot/points **UP** and **DOWN**, use the screw (3) on the top of the laser barrel and screws (8) and (9) at the side of the laser barrel:

To adjust the laser dot position **UP**:

- First loosen screws (8) and (9) by turning them **counter-clockwise**. Then tighten screw (3) by turning **clockwise**. Handle the screws with the utmost care and by small steps. Check several shots to the target to see if the laser dot positioning meets your expectations.

To adjust the laser dot position **DOWN**:

- First loosen screw (3) by turning it **counter-clockwise**. Then tighten screws (8) and (9) by turning **clockwise**. Handle the screws with the utmost care and by small steps. Check several shots to the target to see if the laser beam positioning meets your expectations.

To adjust the position of the laser dot **LEFTWARD** and **RIGHTWARD**, use screws (8) and (9) at the side of the laser barrel as follows:

To adjust the laser dot position **leftward**:

- first loosen screw (8) by turning **counter-clockwise**. Then tighten screw (9) by turning **clockwise**. Handle the screws with the utmost care and by small steps. Check several shots to the target to see if the laser dot positioning meets your expectations.

To adjust the laser dot position **rightward**:

- first loosen screw (9) by turning **counter-clockwise**. Then tighten screw (8) by turning **clockwise**. Handle the screws with the utmost care and by small steps. Check several shots to the target to see if the laser dot positioning meets your expectations.



If the screws put up too much resistance, do not try to overcome this resistance with greater force. This may destroy the threads in the body of the laser barrel. We recommend removing the screw that resists too much and checking the threads for cleanliness. If necessary, remove dirt with compressed air. If the problem cannot be fixed, contact your distributor.

BATTERY REPLACEMENT

When the LED indicator flashes once or is constantly flashing, replace the battery.

- Unscrew the battery cover (A) from the laser barrel.
- Remove the discharged battery using the ribbon (B) and insert a new one (AAA 1,5V Alkaline). Pay attention to the correct polarity of battery!
- Reinstall the cover (A).

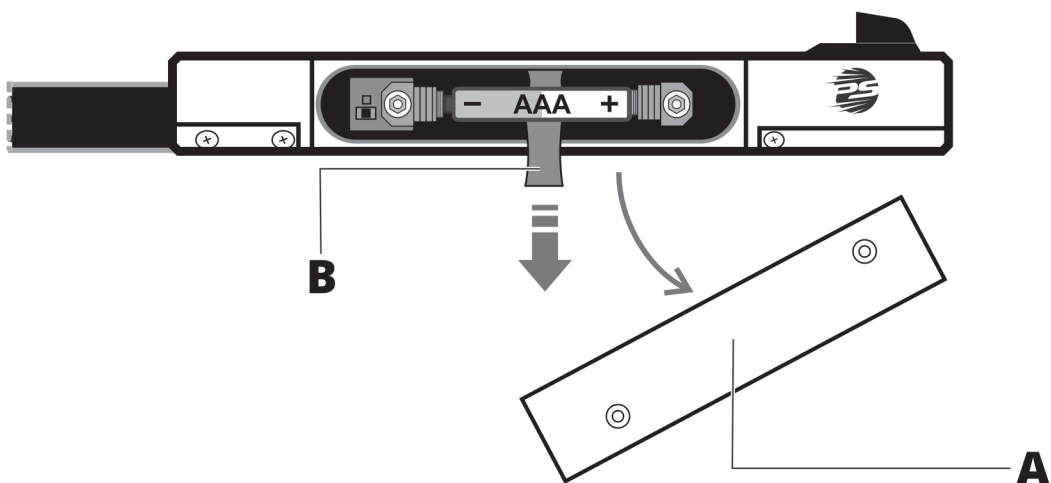

SAFE USAGE

After connecting the laser barrel to a simulator (gun), please follow the following rules:

BEFORE USAGE

- The laser barrel must be used in accordance with these Instructions only. Never use the laser barrel for purposes other than those for which it is designed. Failure to follow these instructions may expose the user to dangerous laser radiation.
- Do not break the security stamp, otherwise you will lose the warranty on the product.
- Use alkaline AAA batteries only. However, never use rechargeable AAA batteries.
- When in public, carry the laser barrel in its original case or in a bag. Persons not familiar with this type of laser barrel may mistake it for a regular weapon and alarm the police.

DURING USAGE

- Never aim at people, animals or uncontrolled areas.
- While handling the laser barrel, observe the general rules for manipulation with a real weapon.
- Do not look into the laser beam directly or through any optical device.

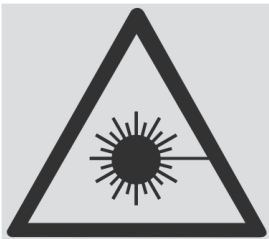

LASER RADIATION
DO NOT LOOK DIRECTLY INTO THE LASER BEAM!
CLASS I. LASER DEVICE

AFTER USAGE

- After use, store the laser barrel with simulator (gun) in its original case.
- Protect the laser barrel against direct sunlight and rain in accordance with the UIPM Rules.



WARNING!

Failure to follow the above stated instructions may expose the user to dangerous laser radiation.

TROUBLESHOOTING

The laser beam trace is barely visible or not visible at all.

Replace the battery.

The detector (a scanning device) does not react to the shot.

Check the target's power supply or replace the battery.

The laser dot impact is evaluated anywhere else but not where the simulator aims.

Adjust the laser dot.

Check correct function of the target.

MAINTENANCE

Keep the laser barrel clean by wiping the dust out of them with a dry cloth. Never use any cleaning agents, solvents or chemical preparations. Do not push the emissive hole optic with any object.

Regularly check the condition of the battery inside the laser barrel body to make sure it does not corrode or leak.

If you will not be using the laser barrel for more than one week, you must remove the battery. Also remove the battery before traveling by plane.

Order replacement parts by e-mail from **business@pentashot.eu** or from PENTASHOT partners and dealers. A list of them can be found at **www.pentashot.eu**.



Only the manufacturer or an authorized individual has the right to replace the simulator's main parts (optics and electronics, including parts of the trigger mechanism).

STORAGE

It is very important to store the laser barrel under the correct conditions to keep it in good, reliable condition. Always do the following:

- Before storing the laser barrel for an extended time, always remove the battery. This prevents internal damage to the laser barrel if the battery leaks.
- Store the laser barrel with simulator (gun) in the original packaging (case) in a dry, dark place out of reach of children.
- Do not place any heavy objects on the case, or items that may leak fluids.
- Protect the laser barrel from weather, including frost and moisture. The optimal storage temperature is between +5 and +30° C. The storage location's air humidity must not exceed 60%. Do not store the laser barrel in a damp environment where there is high risk of corrosion.

WARRANTY

A warranty repair shall apply exclusively to defects that have provably arisen during the effective warranty period, namely as a result of a material defect or a manufacturing defect. Defects arising in such a manner may be remedied only by the manufacturer or an authorized maintenance and service center. The buyer can make a claim under the warranty against the manufacturer or authorized dealer, as the case may be.

The warranty period shall become effective on the day of purchase or delivery of the Goods to the Buyer, and the warranty remains valid for 24 months.

In particular, the following cases are excluded from the warranty repair:

- The product has not been returned to the dealer/manufacturer with the proof of purchase.
- Wear and tear due to the use of the product or damage to the product (incl. damage caused by unskilled installation, improper commissioning, non-compliance with the procedures defined in the instructions for use, etc.).
- Damage to the product caused by contamination, an accidental or disaster event or occurring as a result of natural or external events such as a storm, fire, water, excessive heat or chill, ingress of a liquid, etc.
- Mechanical damage to the product (e.g. caused by fall, breaking, etc.) or damage arising during the transportation.
- Damage, unauthorized design modifications, improper modification of the product or any other interventions in the product conducted by unauthorized persons or maintenance and service centers.

DISPOSAL



Once the laser barrel ends its lifetime, do not dispose of it along with other household waste. Take it to a waste disposal site of raw materials or let it be disposed at a specialized company capable of recycling such a material.

The used battery must not be thrown into a standard dustbin. Collect all used the batteries and dispose them at specialized collection points.

NOTES

NOTES

NOTES



www.pentashot.eu

Address: PENTASHOT EU s.r.o.
Zámecká 2315/9
70200 Ostrava

E-mails: jiri@pentashot.eu
business@pentashot.eu
info@pentashot.eu

Delivery address: PENTASHOT EU s.r.o.
Kosmova 1090/11
70200 Ostrava

Phone numbers: +420 605 252 433
+420 773 002 110
+420 607 056 112